

READER GUIDE



EVERLASTING

A PLAY BY STEPHEN RADFORD

● SUMMARY ● CAST ● SUGGESTED STAGE
LAYOUT ● CONTACT

SUMMARY

TITLE: Everlasting.

WRITTEN BY: Stephen Radford

TAG: It all hinges.

MEANING: (1) refers literally to eternity, and (2) Everlasting also refers to a flower of the daisy family with a papery texture, retaining its shape and colour after being dried, especially a helichrysum. Overall this is a reference for the preservation of a beautiful thing.

SETTING: Urban Australia, circa 2000-2001.

SYNOPSIS: Tony is grieving the loss of Kandis, a young raven haired girl who took her life. A mutual friend, Rebekah is concerned as Tony avoids taking responsibility of a journal of stories of which Kandis wished to have published. In order to get him on track, she asks her housemate Riley (a struggling writer) to spend time with Tony and guide him through the creative process. With pained dark humour, they take the path of distraction in the shape of a screenplay experiment that allows all to chase the theoretical underpinnings of the indie show business dream. Riley soon realises however that there are extraordinary forces at play.

TYPE: 3 Act play (85 pages) - Adult themes, intense reactive energy.

CAST OF CHARACTERS

PRINCIPLE CAST

TONY: A struggling painter, profound thinker who leads a steady job by day, and turns to alcohol, drugs in order to pursue the artist within. He has an obsession with recently deceased friend, Kandice. He is smart and resourceful, however he does carry a dark side which is self-serving, full of cunning, and even though he is open about his lifestyle, his deeper self is a mystery that only he can reach.

REBEKAH: A new age single girl who likes to fix broken people; whether it be at the behest of being attracted to them, or in other cases just plain feeling sorry. Empathy is strong, however patience is short. She is spiritual with her love of tarot, Nag Champa incense, pot scoring and smoking. Vocally explosive when others are quiet, but she remains quiet when others get heated.

KANDIS: Smart, beautiful, broken and no longer living; having killed herself to make a point to her parents about the importance of having complex emotional needs. Smack was her fix, and writing was her release. She now haunts Tony in the afterlife. The ghost of KANDIS is determined to get what she wants, despite how it affects those who she was closest to.

RILEY: The writer. The traveller from England who just wants to find a project to ease his mind while trying to find ways to make money and stay in Oz. He keeps his cards close, and it although dedicated to his craft, doesn't really know what it is he is capable of. He trusts without question and doesn't care if others take advantage of him. He is a follower and not a leader.

MARTIN: A lean-to Buddhist enthusiast who experiments with psychedelics and incubates from his room. He is Cate's ex but they remain friends – without benefits but with a sense of co-dependency. He loves his tarot deck, walks barefoot, hugs trees and is generally mellow, like a laughing tea-towel.

SUPPORTING ROLES

MR TAYLOR: A mild mannered elderly man who has MARTIN squatting in his shed without permission. He is a devoted husband and naïve in his old age.

FICTIONAL DEAN: A fictional imagining of the character for the film within the play. Doctor.

FICTIONAL ANITA: A fictional imagining of the character for the film within the play. Junkie.

FICTIONAL LAURA: A fictional imagining of the character for the film within the play. Daughter of Lance.

EVERLASTING: A PLAY BY STEPHEN RADFORD – PRESS RELEASE

FICTIONAL RYAN: A fictional imagining of the character for the film within the play. Backpacker. He is accompanied in the film by girlfriend Jasmin, but it seems she is absent from the material that is rehearsed within this play.

FICTIONAL LANCE: A fictional imagining of the character for the film within the play. Bartender. He is the mirror image of TONY.

SUGGESTED STAGE LAYOUT

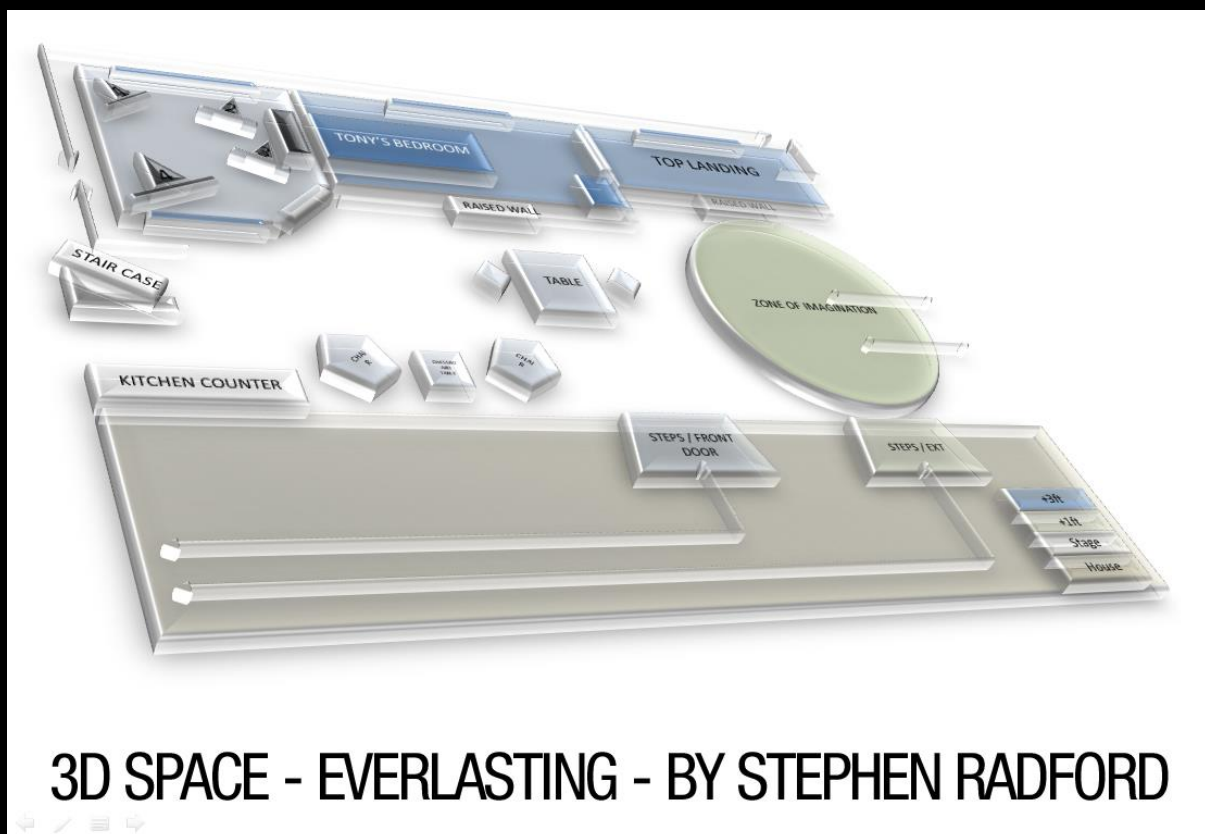
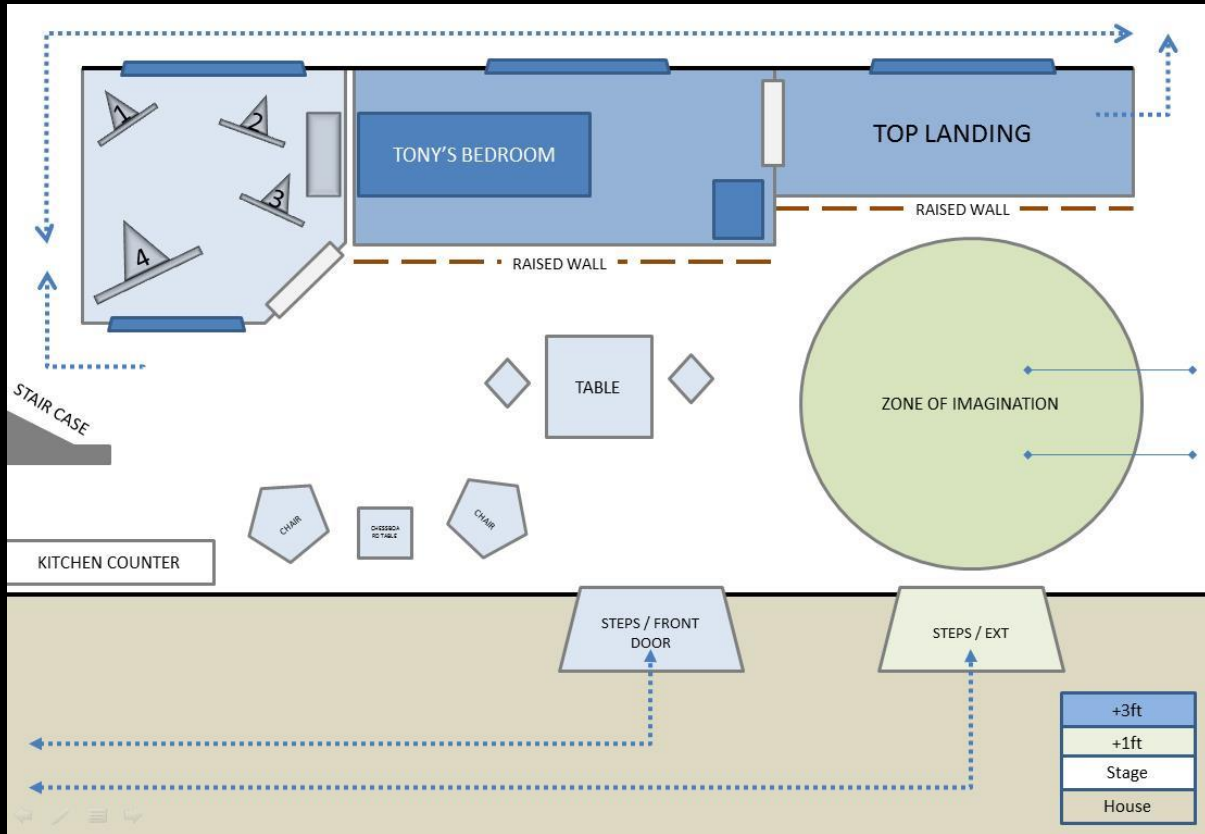

CONTACT

For assistance in any production areas that involve this play, please contact the playwright: stephen@stephenradford.com

